

# Rubber Trails & Surfaces Canada Ltd.

[www.rubbertrailsandsurfaces.ca](http://www.rubbertrailsandsurfaces.ca)

815 HWY 336  
Upper Musquodoboit  
Nova Scotia Canada B0N 2M0  
Tel.: (902) 568-2469  
Fax: (902) 568-2460  
[info@rubbertrailsandsurfaces.ca](mailto:info@rubbertrailsandsurfaces.ca)

## Rubber Flex L Curbs

With a 3 Year material warranty, our Rubber Flex L Curb is designed specifically for artificial turf fields and is made from 100% recycled rubber. This Safety Curbing is easily installed and is available in a 4 inch and 6 inch high profile. Remains flexible in all weather conditions.

It can be painted with a protective UV coating and can be embossed with your field or university name. If you want to reduce the chance of injury and provide better safety for your athletes, stop using traditional edging such as concrete or wood. Protect them and protect yourself with our Rubber Flex Curbs.

**Custom designs also available.**

### **Product Weight:**

- 4 inch L Curb 7.5 lb/lft - 60 lb/unit - 1920/skid (32)
- 6 inch L Curb 10.75 lb/lft - 86 lb/unit - 2752/ skid (32)

### **Features Include:**

- 4in & 6in High Profiles
- 100% recycled rubber
- Remains Flexible in all Weather Conditions
- Water Drain Ports in Base for Superior Drainage
- Easy Installation
- Head Impact Absorption Properties ASTM F-1292-99
- Durable & Long Lasting
- UV Protective Coating
- Can be Painted
- Can be Embossed (field or university name)

**Small Artificial Sport Field  
(ASF Rubber Flex Curb)**

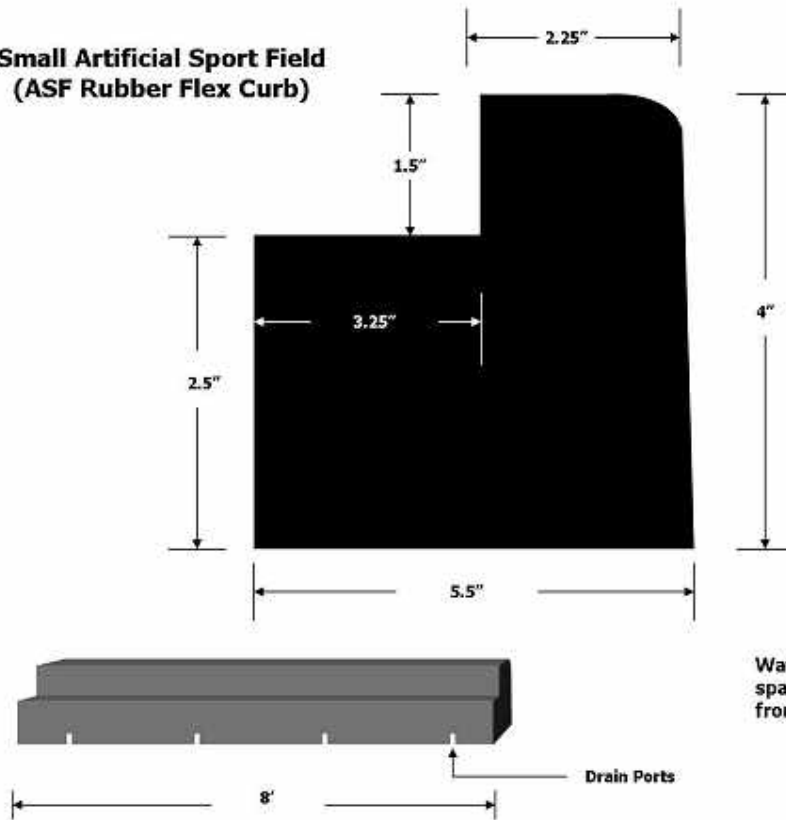

Water Drain Ports are spaced 2' apart and begin 1' from each end of the curb.

**Large Artificial Sport Field  
(ASF Rubber Flex Curb)**  
\*Water Drain Ports are the same as the smaller curb

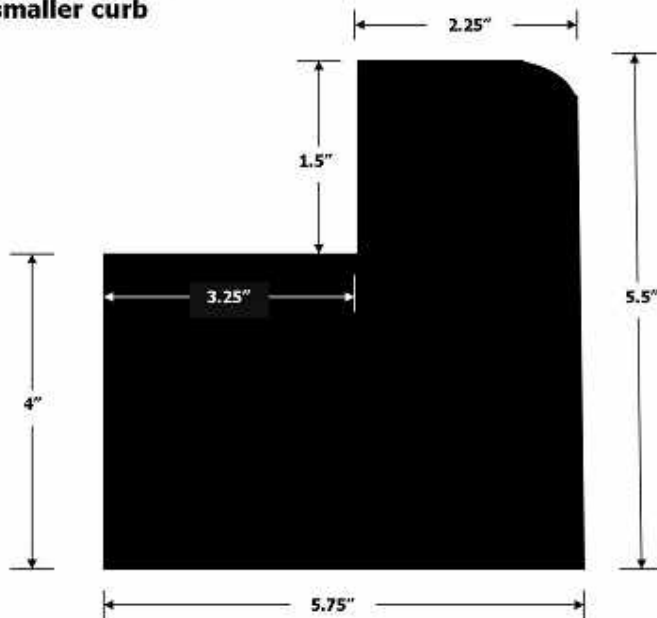

**Small Artificial Sport Field  
(ASF Rubber Flex Curb)**

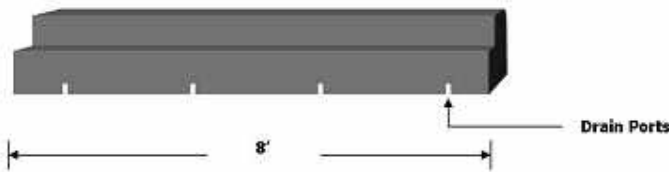
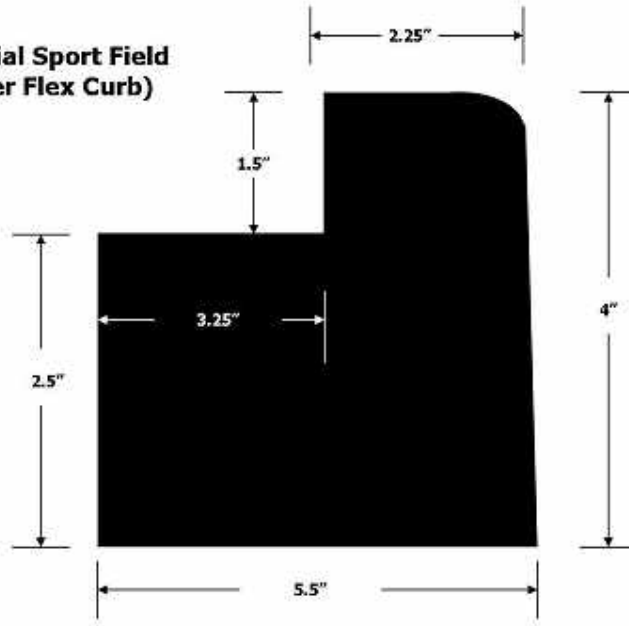

Water Drain Ports are spaced 2' apart and begin 1' from each end of the curb.

**Large Artificial Sport Field  
(ASF Rubber Flex Curb)**  
\*Water Drain Ports are the same as the smaller curb

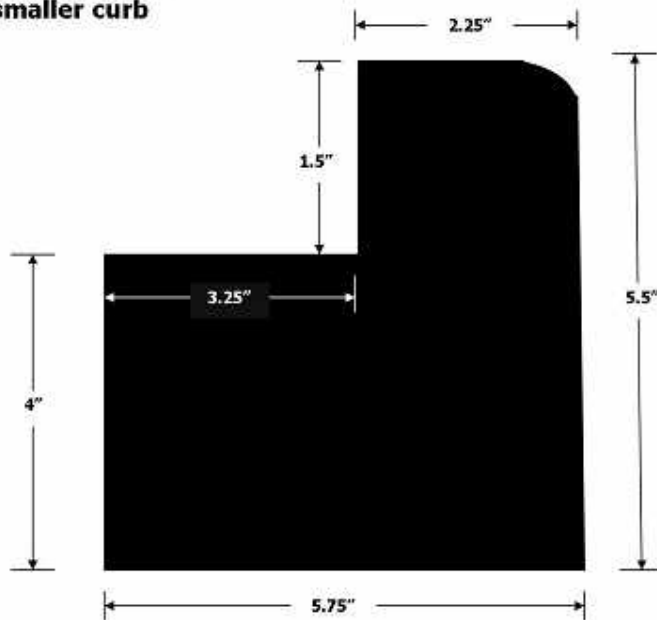

SMALL ARTIFICIAL SPORT FIELD (ASF RUBBER FLEX CURB)

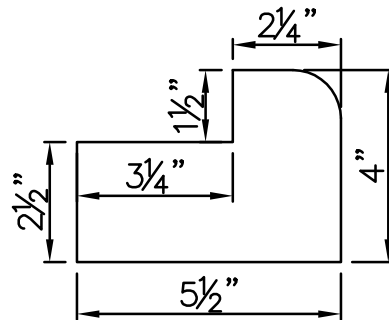

END PROFILE

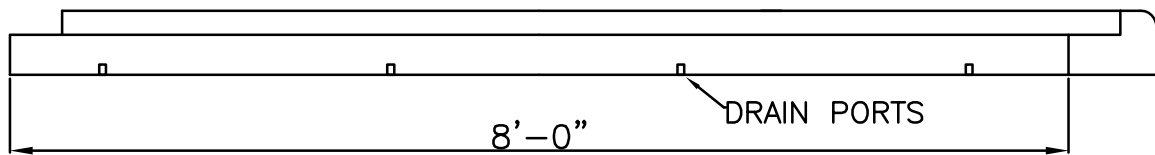

WATER DRAIN PORTS ARE SPACED 2'-0" APART  
AND BEGIN 1'-0" FROM EACH END OF THE CURB

SIDE VIEW

RTS Canada Ltd.  
Rubber Trails & Surfaces Canada Ltd.  
815 Hwy 336 Upper Musquodoboit  
Nova Scotia Canada B0N 2M0  
Tel: (902) 568-2469  
email [steve.benison@ns.sympatico.ca](mailto:steve.benison@ns.sympatico.ca)

LARGE ARTIFICIAL SPORT FIELD (ASF RUBBER FLEX CURB)

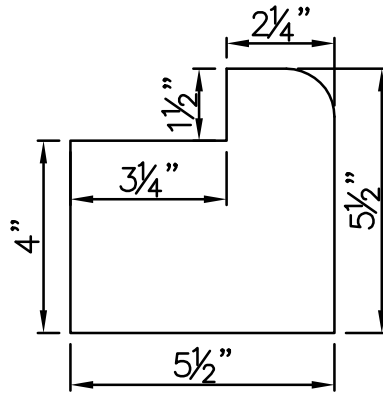

\*WATER DRAIN PORTS ARE THE SAME AS THE SMALLER CURB

END PROFILE

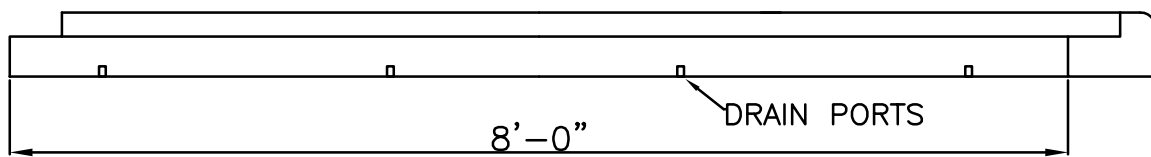

WATER DRAIN PORTS ARE SPACED 2'-0" APART  
AND BEGIN 1'-0" FROM EACH END OF THE CURB

SIDE VIEW

RTS Canada Ltd.  
Rubber Trails & Surfaces Canada Ltd.  
815 Hwy 336 Upper Musquodoboit  
Nova Scotia Canada B0N 2M0  
Tel: (902) 568-2469  
email [steve.benison@ns.sympatico.ca](mailto:steve.benison@ns.sympatico.ca)

## Rubber Flex L Curbs with Built in Drainage Trench

This product was engineered to provide better water drainage for rubber running track and artificial turf combinations.

Each 8' length contains a water port, which delivers excess water from the track surface directly into the drainage system under the artificial turf fabric. This greatly reduces the amount of water that would otherwise have to drain through the artificial turf infill (rubber/sand) as well as the fabric backing.

The trench grating is made of 1/8 inch thick slotted aluminum, providing a strong, good looking and long lasting cover for many years.

The aluminum grate is securely fastened with stainless steel screws and can easily be removed to allow for full access to the drain ports.

***Why use concrete when our Rubber Flex Curb will provide you with both the safety and drainage your project requires.***

### **Features Include:**

- 8.5in wide x 3.5in high x 8ft long
- 2in wide x 2.5in high water trough
- 100% recycled rubber
- Remains Flexible in all Weather Conditions
- Easy Installation
- Slotted aluminum grating
- Stainless steel anchors (grating)
- Drain port in every length
- Durable & Long Lasting
- UV Protective Coating
- Can be Painted
- Can be Embossed (field or university name)



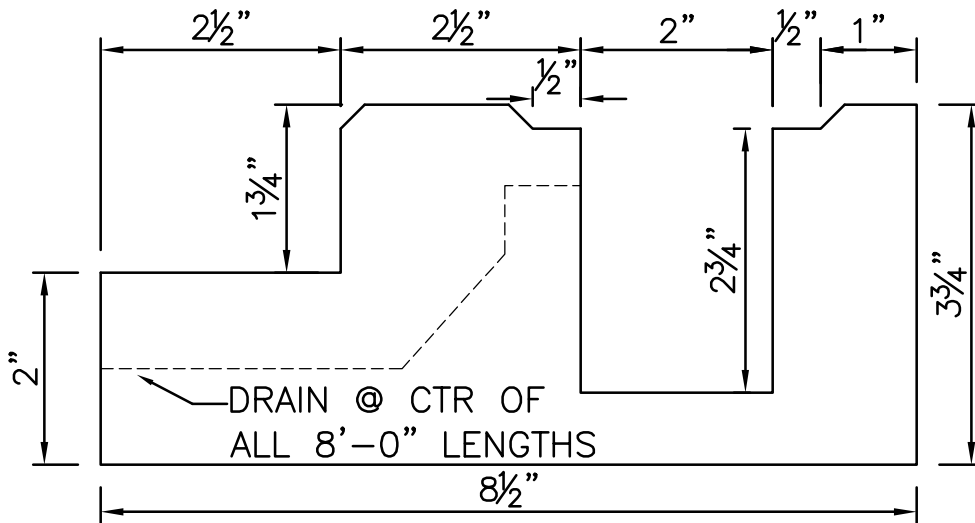

8FT LONG, 5" WATER PASSAGE OPENING IN CENTER OF CURB, SLOTTED ALUMINUM GRATING 1/8"x3" END PROFILE

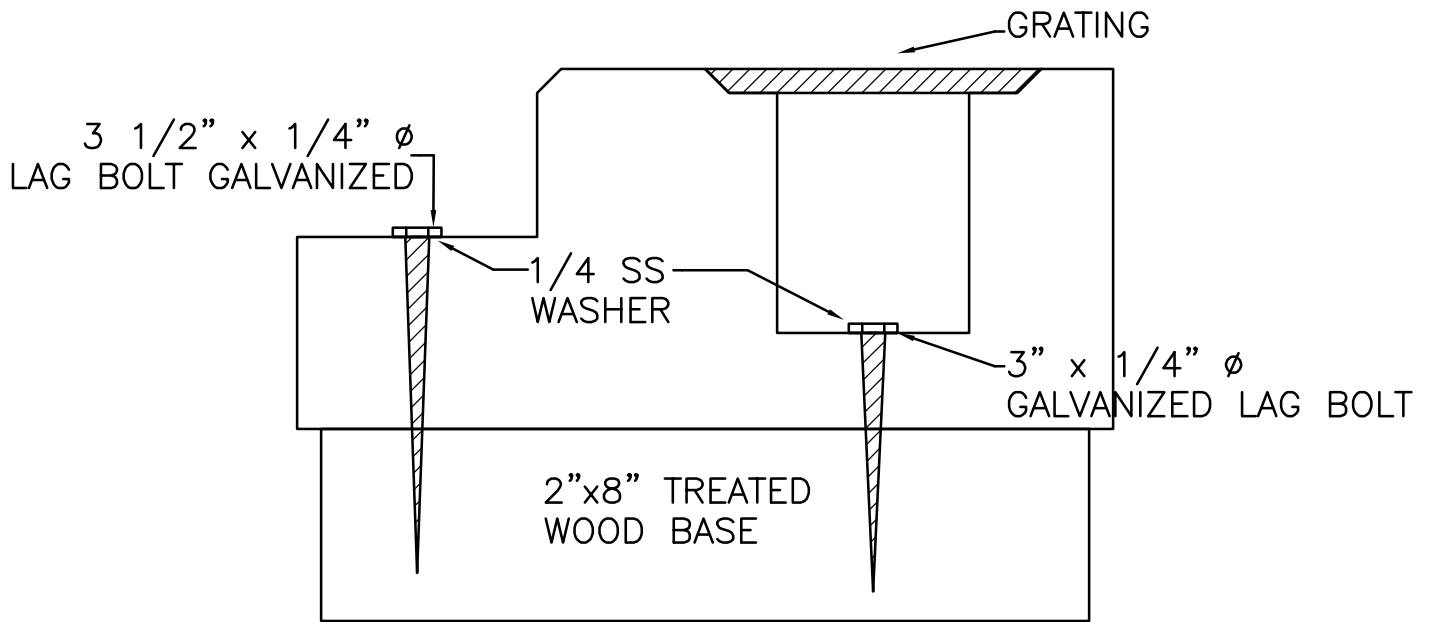

ANCHOR DETAIL

RTS Canada Ltd.  
 Rubber Trails & Surfaces Canada Ltd.  
 815 Hwy 336 Upper Musquodoboit  
 Nova Scotia Canada B0N 2M0  
 Tel: (902) 568-2469  
 email [steve.benison@ns.sympatico.ca](mailto:steve.benison@ns.sympatico.ca)

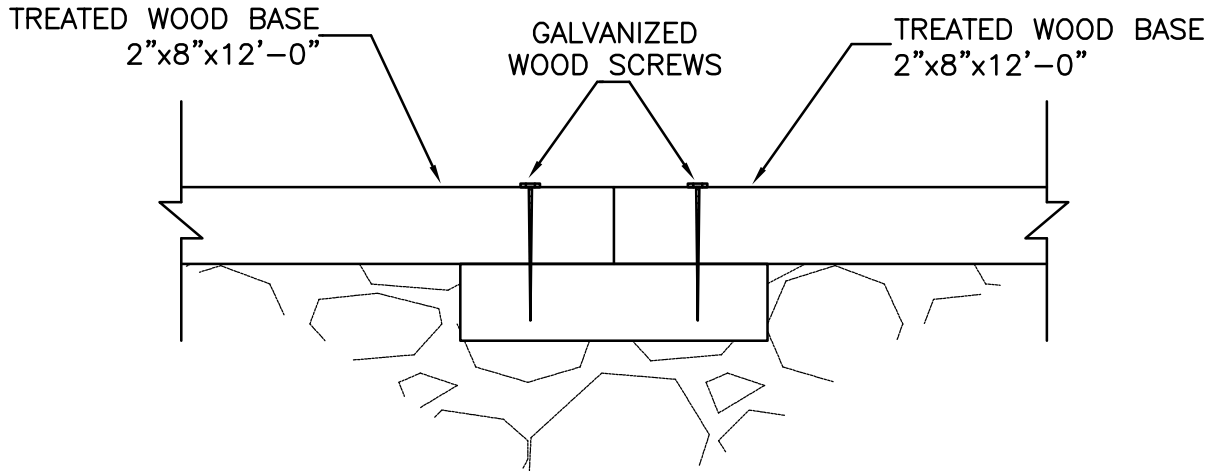

SIDE VIEW OF WOOD BASE

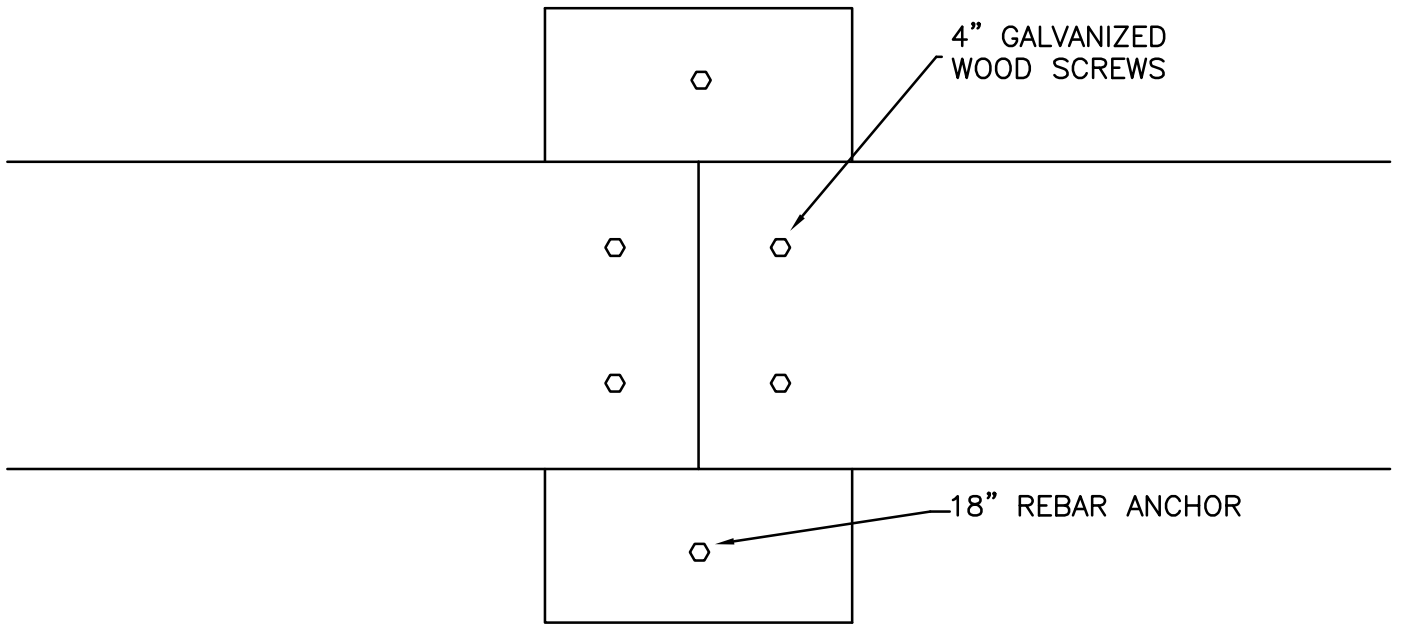

TOP VIEW OF WOOD BASE

RTS Canada Ltd.  
Rubber Trails & Surfaces Canada Ltd.  
815 Hwy 336 Upper Musquodoboit  
Nova Scotia Canada B0N 2M0  
Tel: (902) 568-2469  
email [steve.benison@ns.sympatico.ca](mailto:steve.benison@ns.sympatico.ca)



## ARTIFICIAL TURF L CURB INSTALLATION INSTRUCTIONS

**NOTE:** ALWAYS BE AWARE OF THE FINISHED CURB HEIGHT REQUIREMENTS

1: Grade the outer perimeter of the sport field 2 feet wider than the finished turf requirements

2: Compact this material (**wet crusher dust**), level this material to the correct height

3: Place a curb on top of compacted base, check at the ledge of the curb where the turf attaches that this is the desired finished height requirement. NOTE: you may have to add or remove some crusher dust to achieve the correct height. Compact again and continue.

4: Once you have the correct height for the base, continue the leveling and compacting where the curb is to be placed.

5: We usually find it a time saver that while the base work is being completed some of the crew is placing the curbs out loosely around the perimeter. Be careful not to disturb the compacted base.

6: Sight and stake out the outside perimeter of the sport field layout. Keep in mind that the carpet edge requirement will be 2.25 inch shorter than the curb.

7: Start placing the L curb at one corner of the field to get the 90 degree angle set. Work out from this point.

8: Using the pre drilled holes in the curb base drive the supplied 18 inch anchors into the ground. Follow the sight string line carefully, so the side of the curb is straight, not wavy.

9: If one person places his foot (out of harms way) on the curb, while the anchor is being installed, this will prevent the curb from moving and displacing the base.

10: Using the Bata Seal adhesive place about 5 passes of adhesive on the end of the already anchored curb.

11: Having 2 people pick up the next curb and carefully place it tightly against the anchored curb. Note: do not drag the curb over the compacted base, this may cause a push up of the base material and this will cause a hump in the curb. Remember it is rubber not wood

12: Before placing the anchors into the holes, be sure the curb is level and even with the previously installed curb.

13: Periodically, during installation have your surveyor sight check the curb height, to make sure that everything is staying at the required height.

14: Once the curb is pushed tightly against the previously anchored curb, knock in the anchors. **Very important:** If you are using a maul or an impact driver, use caution not to hit the curb, only the pin, if you hit the curb several times or drive the anchor into the ground too much the curb will dent inward into the compacted base and again cause an uneven look to the finished installation.

15: With the trowel provided screed off any excess adhesive that may push out from the joint. NOTE: We usually have a plastic container and rag with us to wipe away any build up on the trowel.

16: Once the curbs have been installed or during installation, periodically go back over the joints, before the adhesive totally cures and see if any of them need additional adhesive or have excess. You want the seam to be as unnoticeable as possible.

## BATA SEAL ADHESIVE PREP

This adhesive is thick and can be a little difficult to pump out with the caulking gun in cold weather. We have a tube heater that warms 6 tubes at a time. If one is not available at your site please find some way to warm this product. A small electric construction heater will do just fine. The warmer it is the easier it spreads.

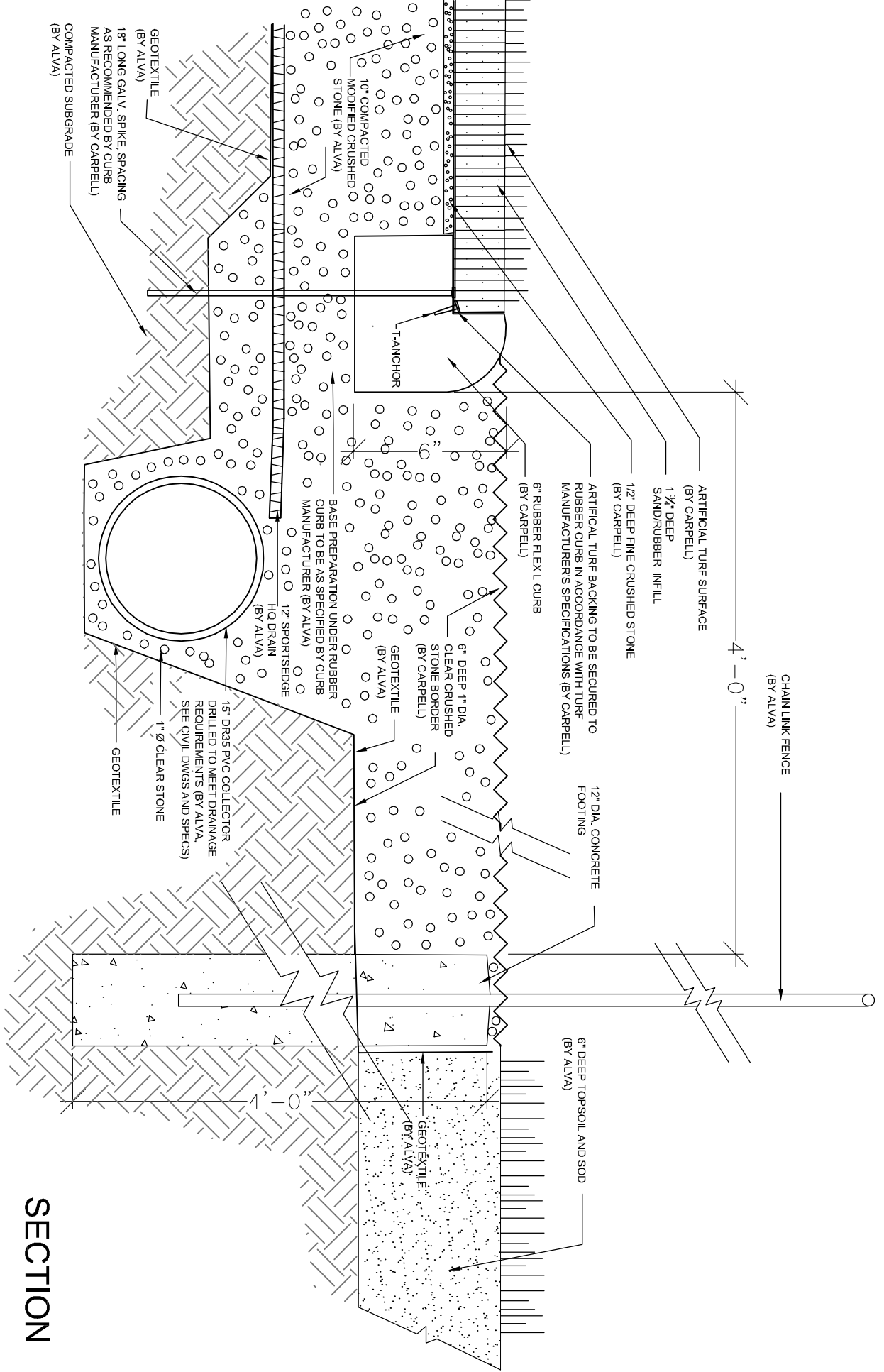

CHAIN LINK FENCE  
(BY ALVA)

4'-0"

ARTIFICIAL TURF SURFACE  
(BY CARPELL)

1 3/4\"/>

1 1/2\"/>

ARTIFICIAL TURF BACKING TO BE SECURED TO  
RUBBER CURB IN ACCORDANCE WITH TURF  
MANUFACTURERS SPECIFICATIONS (BY CARPELL)

6\"/>

12\"/>

6\"/>

6\"/>

GEOTEXTILE  
(BY ALVA)

BASE PREPARATION UNDER RUBBER  
CURB TO BE AS SPECIFIED BY CURB  
MANUFACTURER (BY ALVA)

12\"/>

HO DRAIN  
(BY ALVA)

15\"/>

1\"/>

GEOTEXTILE

GEOTEXTILE  
(BY ALVA)

18\"/>

COMPACTED SUBGRADE  
(BY ALVA)

**SECTION**